

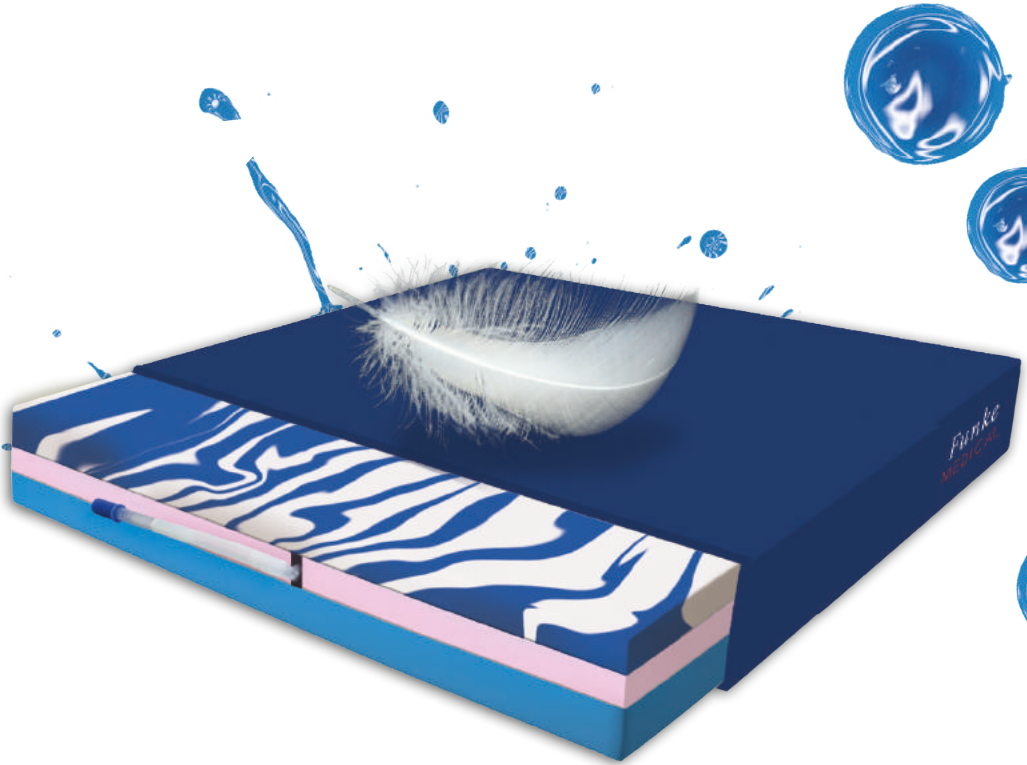

DECUBITUS THERAPY SEAT CUSHION



XAIR[®]
HYBRID

- AIR-CELL SEAT CUSHION -

For active wheelchair users!



Your retailer:



- 2010: Silver World Championship (Birmingham, GB)
- 2011: Gold European Championship (Nazareth, IL)
- 2012: Gold Summer-Paralympics (London, GB)
- 2013: Silver European Championship (Frankfurt, DE)
- 2014: Silver World Championship (Toronto, CA)
- 2015: Gold European Championship (Worcester, GB)
- 2016: Silver Summer-Paralympics (Rio de Janeiro, BR)
- 2017: Silver European Championship (Tenerife, ES)
- 2018: Bronze World Championship (Hamburg, DE)



Decubitus therapy air-cell seat cushion
for active wheelchair users!



- Autoclavable according to RKI*1 guidelines
- Applicable for pain therapy
- Up to stage 4 (EPUAP)
- Very high risk (Norton-, Braden-, Waterlow-Scale)

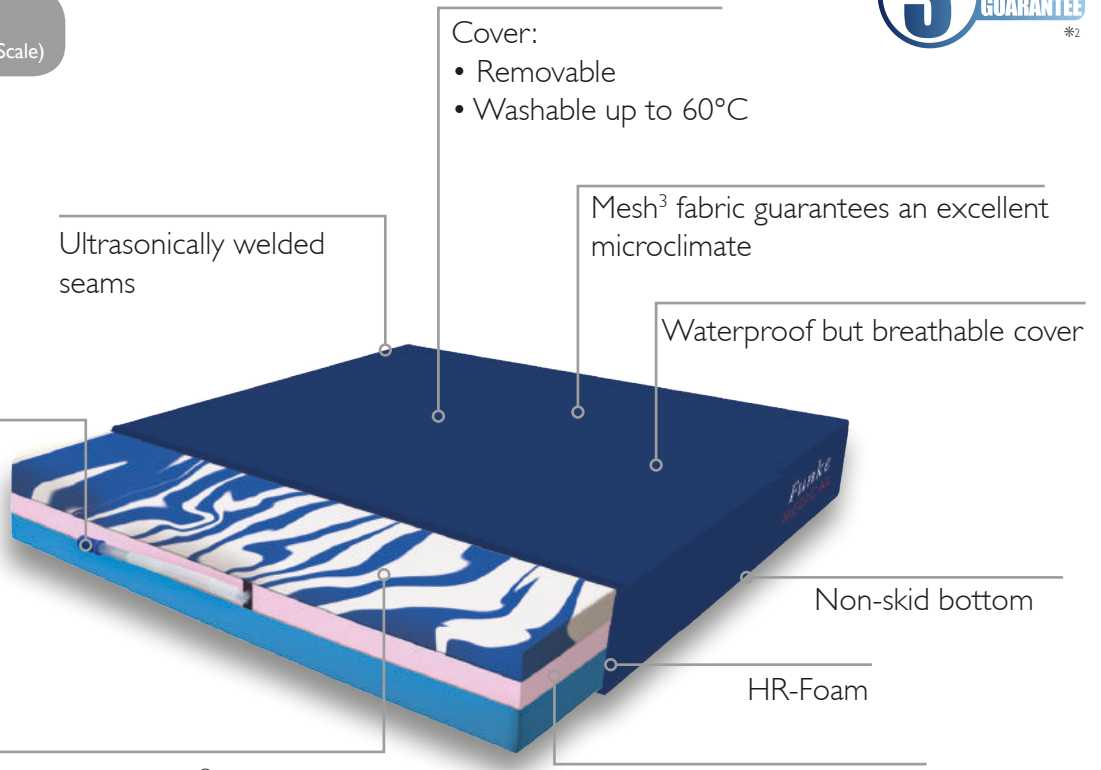

Unique Geltouch®-technology with cooling-effect

Hyperelastic three-layered comfort core: Geltouch®-top plate

Size in cm Width x Length x Height	Item No.	Size in cm Width x Length x Height	Item No.
38 x 40 x 8	XAIR3840	45 x 44 x 8	XAIR4544
40 x 40 x 8	XAIR4040	45 x 46 x 8	XAIR4546
40 x 42 x 8	XAIR4042	46 x 51 x 8	XAIR4651
41 x 46 x 8	XAIR4146	48 x 42 x 8	XAIR4842
42 x 40 x 8	XAIR4240	48 x 44 x 8	XAIR4844
42 x 42 x 8	XAIR4242	48 x 46 x 8	XAIR4846
42 x 44 x 8	XAIR4244	50 x 42 x 8	XAIR5042
42 x 46 x 8	XAIR4246	51 x 44 x 8	XAIR5144
42 x 52 x 8	XAIR4252	51 x 46 x 8	XAIR5146
45 x 42 x 8	XAIR4542	52 x 52 x 8	XAIR5252

Breathable open-cell Geltouch®-foam + HR-foam + Visco-foam	Autoclavable 105°C / 221°F	Cover material virus- and bacteria-proof accord. ASTM 1670 + 1671	Waterproof but permeable to water vapour	Optimised pressure relief	Bi-elastic cover to minimise shear forces	CE marking	Maintenance-free	Flame retardant DIN 597 (I+II) CRIB 5	Patient weight: 0 - 120 kg	Very light

*1 Robert-Koch-Institute (RKI) is a part of the Federal Ministry of Health in Germany. It is responsible for disease prevention and control.
*2 Guarantee applies to functional properties of the cushion core (pro rata basis)!



Handle for easy carrying

Soft protective cover with hook-and-loop fastener



1

Lift the protective cover.

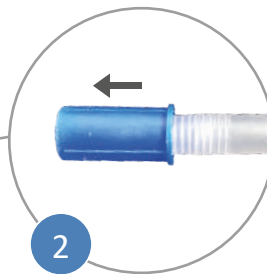

2

Open the valve by pulling the blue lock and wait approx. 30 seconds, until the air-cells have inflated automatically.
(Valve lock can not fall off.)

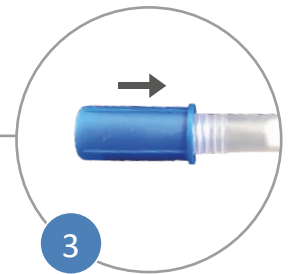

3

Close the valve by pressing.



4

Put the cushion on the wheelchair or seat.

(The handle must point to the front and the attached arrows must point upwards.)

Sit on the cushion.

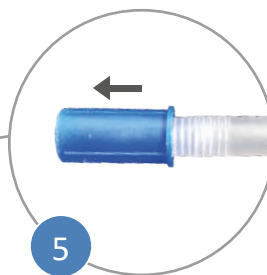

5

Carefully open the valve again until the ideal sitting comfort is achieved.



6

Close the valve and the protective cover.

XAIR[®] HYBRID

- AIR-CELL SEAT CUSHION -

For active wheelchair users!

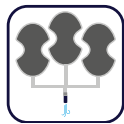
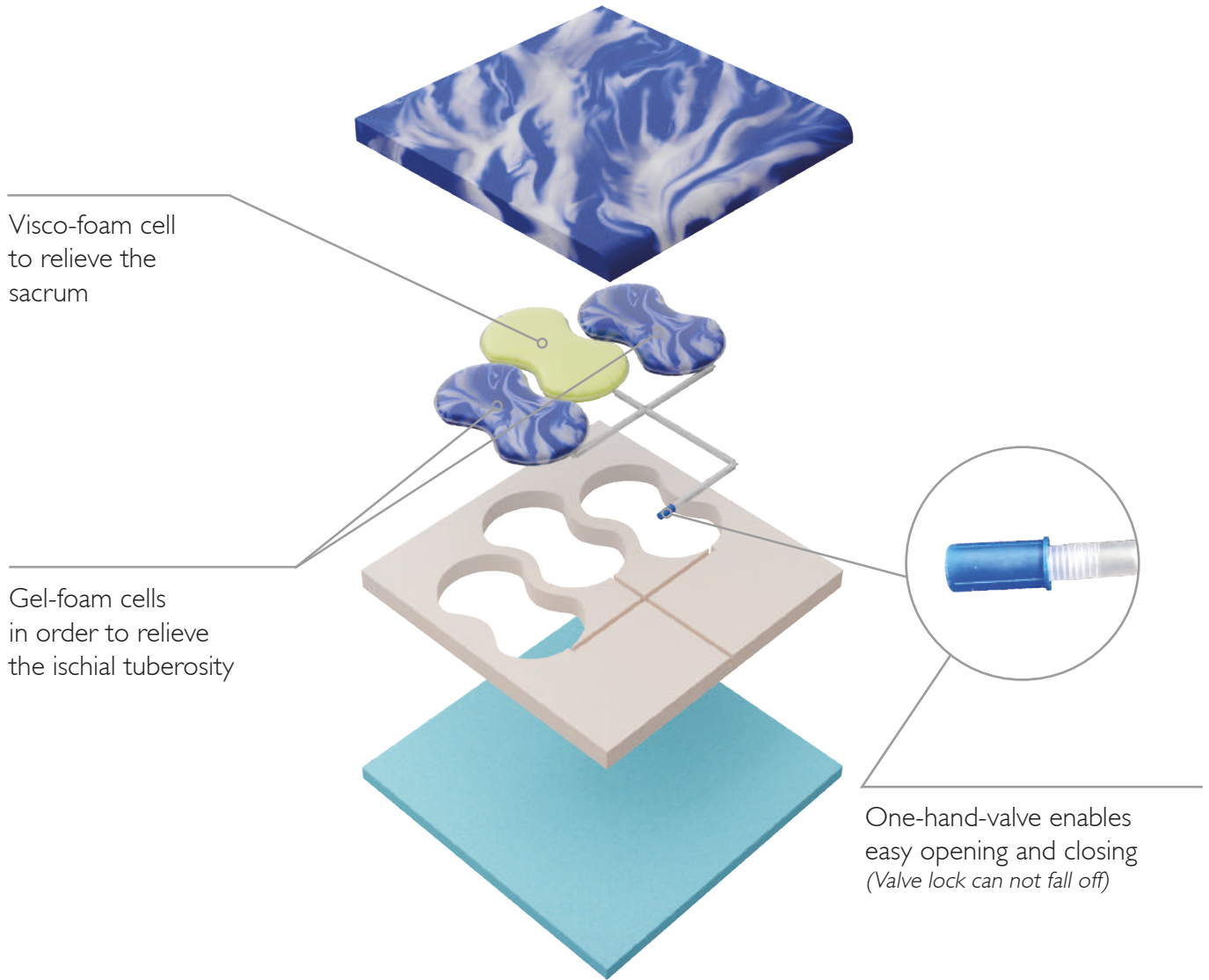

3-chamber seat cushion provides optimum pressure relief



Individually adjustable for ideal seating comfort



No pump or other tools necessary



Fast and easy adaptation to external pressure conditions



No default risk due to self-inflating FOAM-IN-CELL-TECHNOLOGY



Very light – 70 % less weight than conventional air-cell seat cushions